

- ① LEVELLED NATURAL SOIL with ORGANICS REMOVED
- ② 4-6" of 3/4" CLEAN CRUSHED GRAVEL for DRAINAGE
- ③ 14" ISO-SLAB MODULE
- ④a 2" INSULATION PANEL
- ④b 3" INSULATION PANEL
- ④c 3" HYDROPEX INSULATION PANEL (for RADIANT FLOOR) (SHOWN)
- ④d or 3" INSULATION PANEL
- TOTAL of INSULATION PANELS: 8" (R34)
- ④d TRANSITION MODULE ISO-SLAB
- ⑤ SKIRT - INSULATION PANEL 3" or 4" at the OUTER PERIMETER
- ⑥ METAL MUDDSILL (C-CHANNEL)
- ⑦ VAPOR BARRIER (OPTIONAL)
- ⑧ WATERPROOFING MEMBRANE at the OUTER PERIMETER
- ⑨ TUBING for HYDRONIC RADIANT FLOOR (OPTIONAL)
- ⑩ REBAR and METAL MESH SPECIFIED by ENGINEER
- ⑪ CONCRETE - THICKNESS: 12" PERIMETER / 6" CENTRE
- ⑫ FINISHING OPTIONS:
- 1- CEMENT BOARD COATED with PARGING
- 2- CEMENT BOARD COATED with PARGING (SHOWN)
- 3- ALUMINUM FLASHING
- ⑬ PERFORATED DRAIN WRAPED in DAMP-PROOF MEMBRANE
- ⑭ BACKFILL SOIL

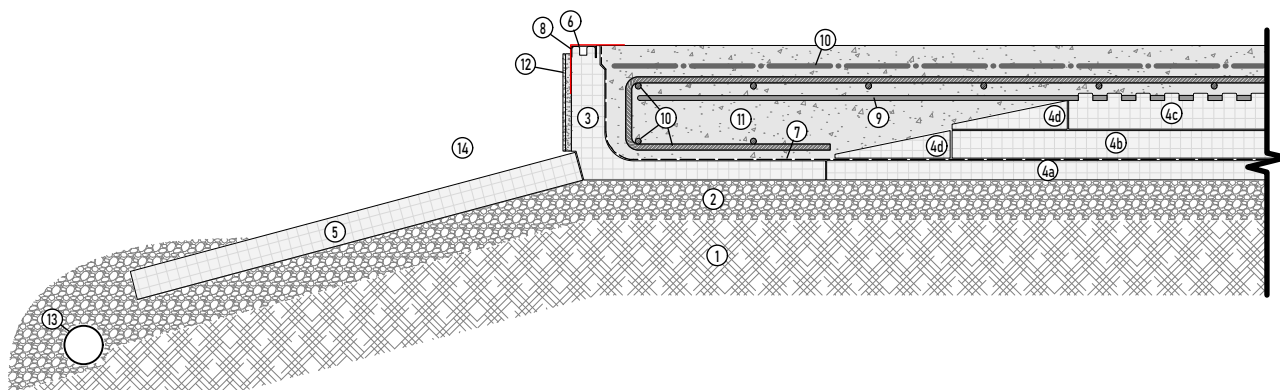

14" SYSTEM

